

Disposal & Dismantling

Article number: 4305712

Light source: LT2362_small_module, LT2362_big_module

Dismantling of light source for disposal purposes

Firstly, disconnect the product from any power supply by disconnecting the plug from the mains socket. Secure it against unauthorized switching on.

1. Remove the screws and take off the glass from the upright.
2. Remove the screws of the PCB to take out the light source element from the upright housing.
3. Remove the screws at the back side of the light source element to access the light source.
4. Remove the glue from the wires and unsolder the wires from the light source. The light source of the upright is now dismantled and can be disposed of according to the relevant legal regulations.
5. Remove the screws on the reading lamp and take off the cover.
6. Remove the glue from the wires and unsolder the wires from the light source. The light source of the reading lamp is now dismantled and can be disposed of according to the relevant legal regulations.

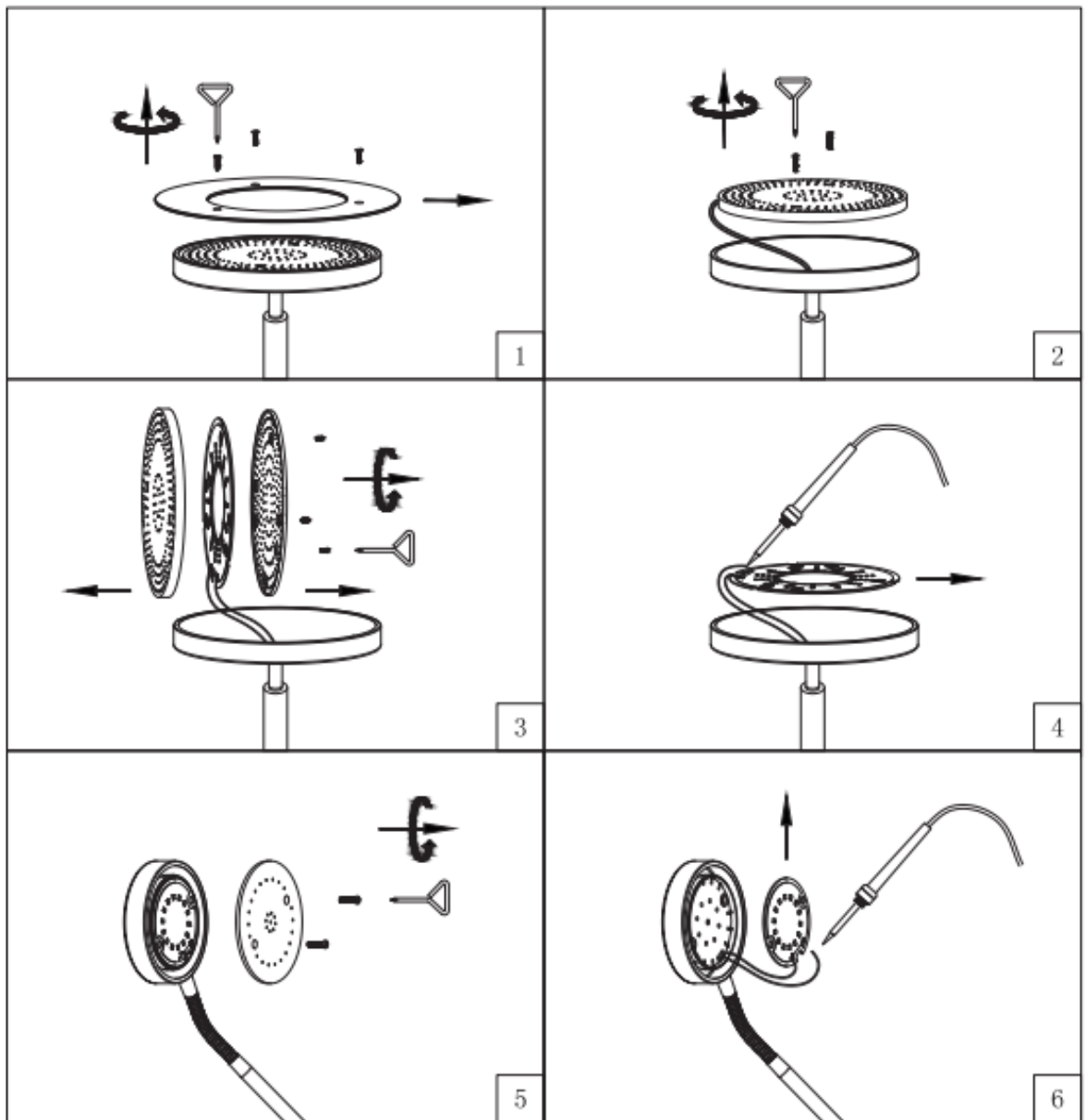

Manufacturer

DI-KA Vertriebsgesellschaft mbH & Co. KG
 Oberstrasse 4
 59755 Arnsberg
 Germany
 Tel: +49 2932 9022580
<http://www.di-ka.net/>